

All dimensions & details given on this drawing are to be checked and verified on site prior to works being undertaken. Any discrepancies and/or variations to the specifications within these drawings or associated documents are to be notified to keystonearchitecture.

Do not scale from these drawings - if in doubt - ask.

All materials shall be fixed, applied or mixed in accordance with the manufacturers written instructions, recommendations and specifications. Variations to specified materials shall be agreed in writing with keystone architecture.

The Contractor shall take into account everything necessary for the proper execution of the works and to the satisfaction of the Local Authority, whether or not indicated on the drawings or in the specification.

This drawing is the copyright of keystone architecture and must not be reproduced without written consent. © keystone architecture 2022

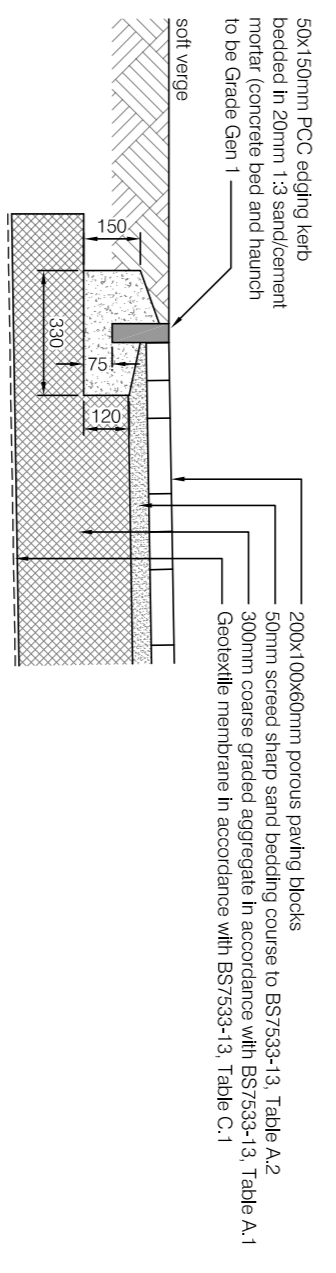
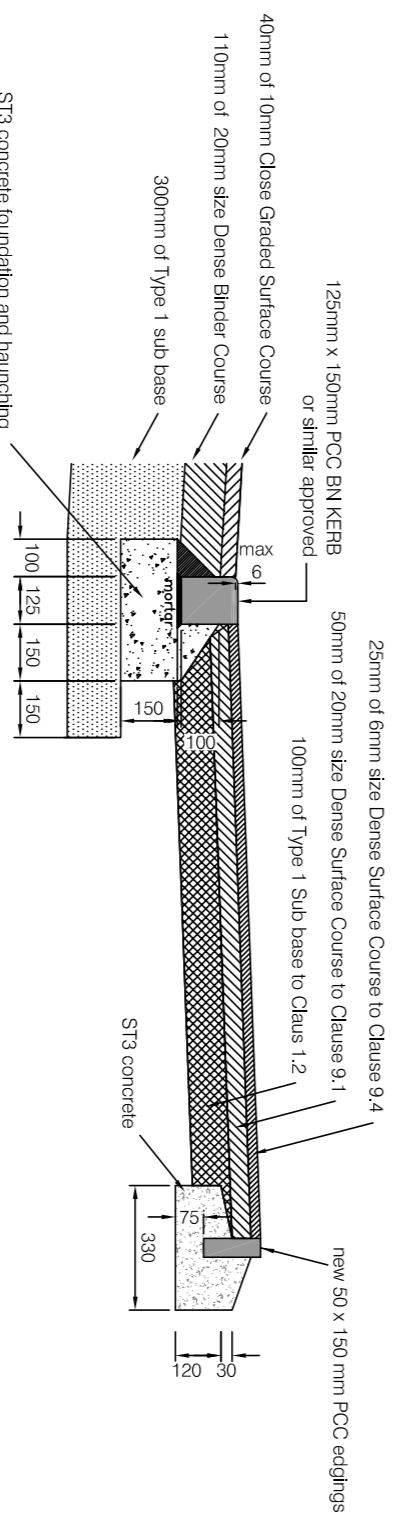
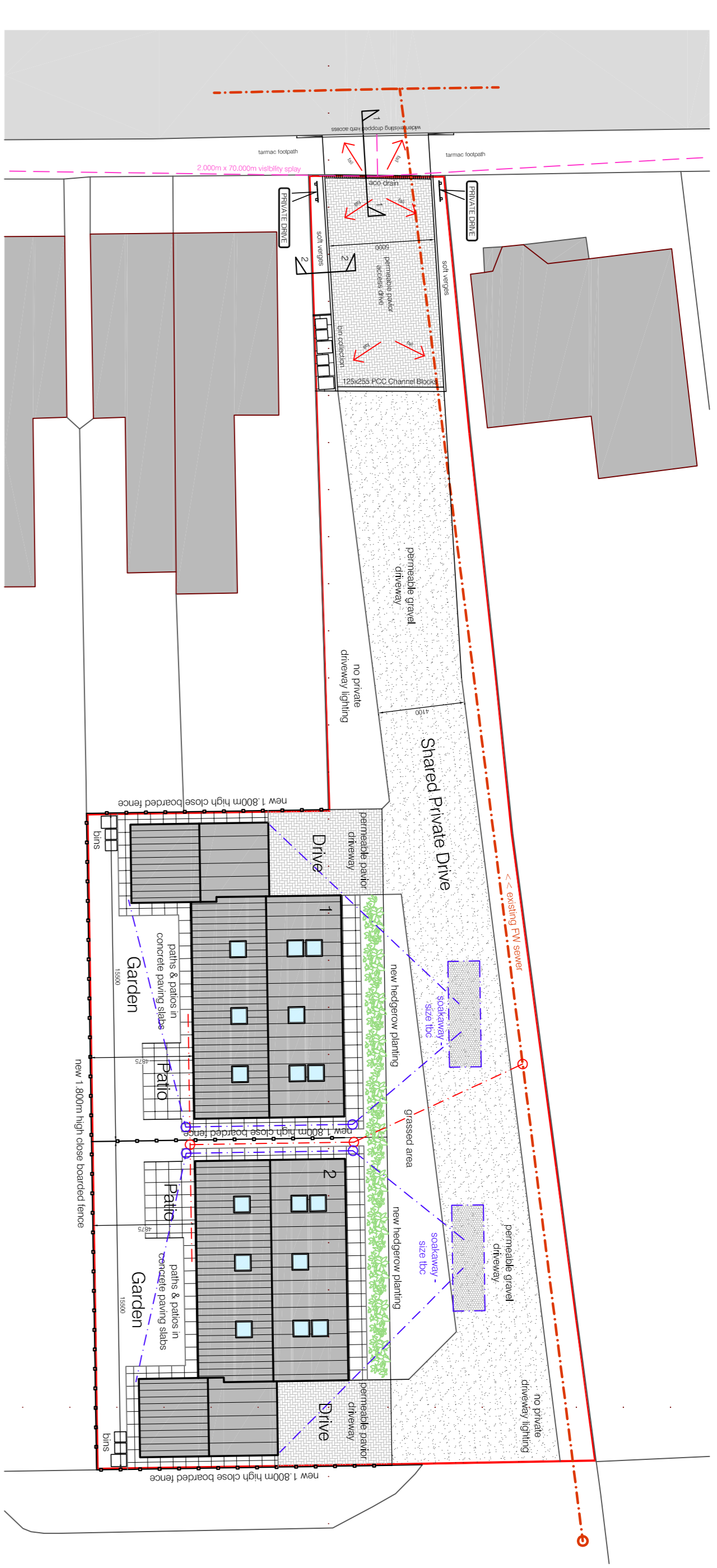

rev.	amendment	date
200	Proposed Drawings Land to Rear of 320-322 Ashby Road.	14.14.13
100	Building Regs	July 22
00	as noted	JCB

keystone architecture

architects
building consultants
energy assessors
project managers

14.14.13
July 22
JCB

01724 230 122
01724 230 122
www.keystonearchitect.co.uk
info@keystonearchitect.co.uk

Retarus House, High Street, Sutton, Surrey, GU1 1BA